

12x20 Standard "Quick-Ship" Buildings

PORTAFAB
Modular Building Systems

Standard "Quick-Ship" Modular Offices & Buildings

Save costs, labor, and materials with modular construction. PortaFab's "quick-ship" modular units come as two, three, or four wall buildings created from the OmniFlex steel stud framing system.

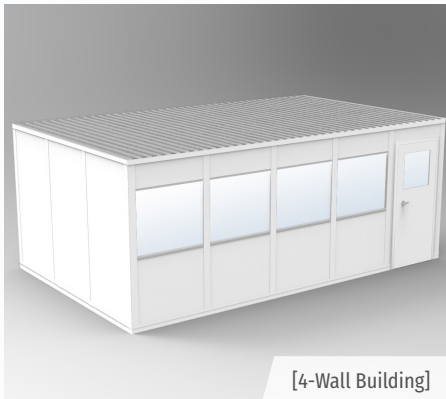

[4-Wall Building]

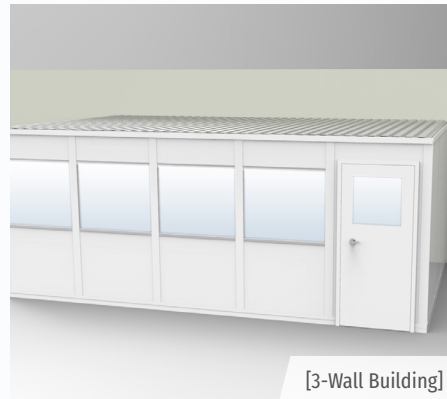

[3-Wall Building]

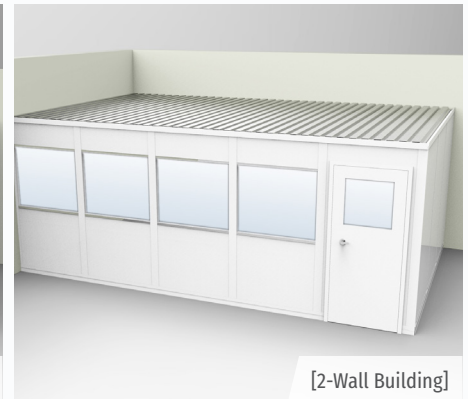

[2-Wall Building]

12'x20' Standard "Quick-Ship" Building Specifications

| | | | |
|----------------------------------|---|--------------------------------|--|
| Width (feet) | 20' 4-1/2" (20' 1-1/4" for 2 & 3 Wall) | Door Style | Swing |
| Depth (feet) | 12' 4-1/2" (12' 1-1/4" for 2 & 3 Wall) | Frame Construction | Painted Steel |
| Height (feet) | 8' or 9' | LED Light Fixtures | 4 (Based on 4-wall Building Configuration) |
| Color / Finish | Gray or White | Outlets | 7 (Based on 4-wall Building Configuration) |
| Approval / Regulations | Fire & Sound Panel: R-11, STC-31 (Class A per ASTM-E84) | Limited Warranty | 1 Year |
| Assembly | Unassembled | Type | 4-Wall, 3-Wall or 2-Wall |
| Clearance Height Interior | 7' 6" With 8' Panels 8' 6" With 9' Panels | Wall Construction | Fire and Sound (F&S) Panels With 1/2" Vinyl Gypsum on Polystyrene Core |
| Door Size | 3' x 7' | Wall Thickness (inches) | 3" |

Pre-engineered modular buildings offer a number of benefits when compared to traditional construction:

Ease of Coordination

PortaFab will handle the entire installation of your building, so that you do not need to spend valuable time away from your job.

Reduced Labor Costs

Prefabricated components can be installed quickly, resulting in a lower cost of labor.

Consistent Quality & Appearance

Our pre-engineered components can be integrated with one another to maintain a seamless and professional appearance.

Adaptability

Our flexible buildings can be expanded or relocated quickly and easily to grow with your company.

No Mess

Pre-engineered components result in a cleaner installation with minimal disruption to surrounding facility.

Green

Since construction waste is reduced with modular construction, a facility can earn LEED points to improve its Green Building Rating.

12x20 Standard "Quick-Ship" Buildings

PORTAFAB
Modular Building Systems

Our complete prefab kits include everything needed for a basic modular inplant office. All models include:

- Interchangeable Wall Panels (Fire & Sound Panels)
- Acoustical Drop Ceiling
- Steel Roof Deck
- Framing (Wiring Posts, Corner Posts, Top & Bottom Channels)
- Connecting Hardware
- Knocked-down Steel Door With or Without Window

Standard "Quick-Ship" Building Options

Doors and Hardware

| | |
|----------------------------|---|
| Steel Door Assembly | <ul style="list-style-type: none"> • 3070 - 20 Gauge Steel Door Assembly - Flush • 6070 - 20 Gauge Steel Double Door Assembly - Flush |
| Glass | 1/4" Clear Tempered Safety Glass |
| Threshold | Aluminum Threshold - 4" |
| Door Louver | Door Louver - 16" x 12" |
| Misc. Hardware | Door Closer, Kickplates |

Window Assemblies

| | |
|-----------------------------|--|
| Fixed Window | 4' or 2' Nominal Width x 3' Nominal Height Glazed With 1/4 Clear Tempered Safety Glass |
| White Sliding Window | 3' x 3' Nominal Dimensions, Installed in Wall Panel Glazed With 1/8" Clear Tempered Safety Glass |

Roof and Ceiling Systems

| | |
|---------------------------|---|
| Acoustical Ceiling | 2' x 4' x 5/8" Mineral Fiberboard With White Steel Grid System |
| Ceiling Insulation | 6" Fiberglass (R-19) |
| Roof Deck | <ul style="list-style-type: none"> • Up to 12' Length • 16' Long Dust Cover Support Beam • 20' Long Dust Cover Support Beam • Dust Cover Support Angle - 12' (Must Be Used Along All Existing Building Walls) |

Climate Control

| | |
|-----------------------|--|
| HVAC Units | 12,000 Btu Cool / 11,600 Btu Heat (230V) or 8,000 Btu Cool / 4,200 Btu Heat (115V) |
| Framed Cutouts | Installed or Material Only (Size Not to Exceed 12 L.F.) |

Electrical Components

| | |
|--|--|
| Light Fixture | 2' x 4' LED Flat Panel Fixture |
| Outlet or Switch | <ul style="list-style-type: none"> • Outlet Without Wiring (15 amp) • Switch Without Wiring (15 amp) |
| Circuit Breaker Boxes | <ul style="list-style-type: none"> • 4-Space • 6-Space • 10-Space |
| Exhaust Fan | 270 cfm Ceiling Mounted Exhaust Fan - Includes Fan, Duct Kit, & Switch (Louver in Door Recommended for Maximum Air Flow) |
| Upgrade to Modular Electric Package | Lights, Outlets (20 amp), and Switch (20 amp) |